

**STAN: B406**  
 Etaža: 4  
 Površina: 108,44m<sup>2</sup>  
 Broj soba: 5  
 Orientacija: IJZ

VIŠESTAMBENA GRAĐEVINA; Velika Gorica, A.K. Miošića

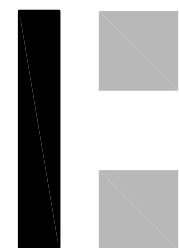
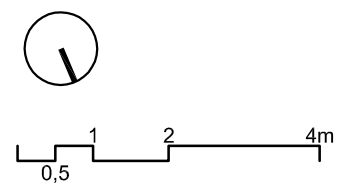
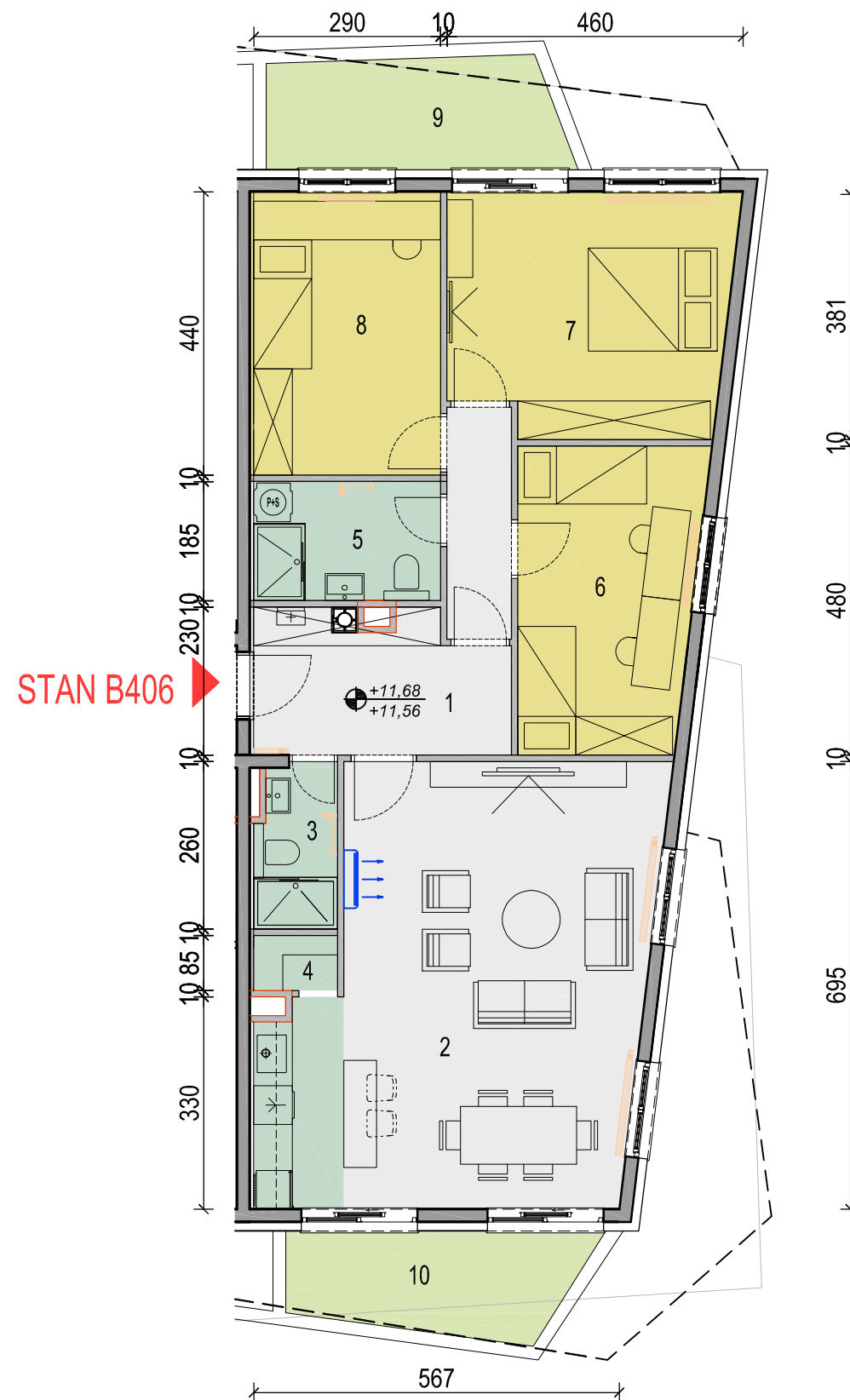

 **RADIJATOR**       **KLIMA**       **PERILICA RUBLJA**

Oznaka	Prostorija	Pod	Površina	Koef	Ukupno
01	Ulaz/Hodnik	parket	11,84 m <sup>2</sup>	1	11,84 m <sup>2</sup>
02	Kuhinja, blag i d.bor.	parket/ker. Pl.	37,12 m <sup>2</sup>	1	37,12 m <sup>2</sup>
03	Wc	ker. pločice	3,16 m <sup>2</sup>	1	3,16 m <sup>2</sup>
04	Gospodarstvo	ker. pločice	1,11 m <sup>2</sup>	1	1,11 m <sup>2</sup>
05	Kupaonica	ker. pločice	5,08 m <sup>2</sup>	1	5,08 m <sup>2</sup>
06	Soba 1	parket	13,32 m <sup>2</sup>	1	13,32 m <sup>2</sup>
07	Soba 2	parket	16,15 m <sup>2</sup>	1	16,15 m <sup>2</sup>
08	Soba 3	parket	13,32 m <sup>2</sup>	1	13,32 m <sup>2</sup>
<b>UKUPNO</b>			<b>101,10 m<sup>2</sup></b>		<b>101,10 m<sup>2</sup></b>
09	Natkriveni balkon	ker. pločice	7,80 m <sup>2</sup>	0,50	3,90 m <sup>2</sup>
10	Natkriveni balkon	ker. pločice	6,88 m <sup>2</sup>	0,50	3,44 m <sup>2</sup>
<b>SVEUKUPNO</b>			<b>115,78 m<sup>2</sup></b>		<b>108,44 m<sup>2</sup></b>